

537 Series AutoSwitch GL

Automatic Switchover System

Liquid Primary with High Pressure Reserve

316L Stainless Steel Components

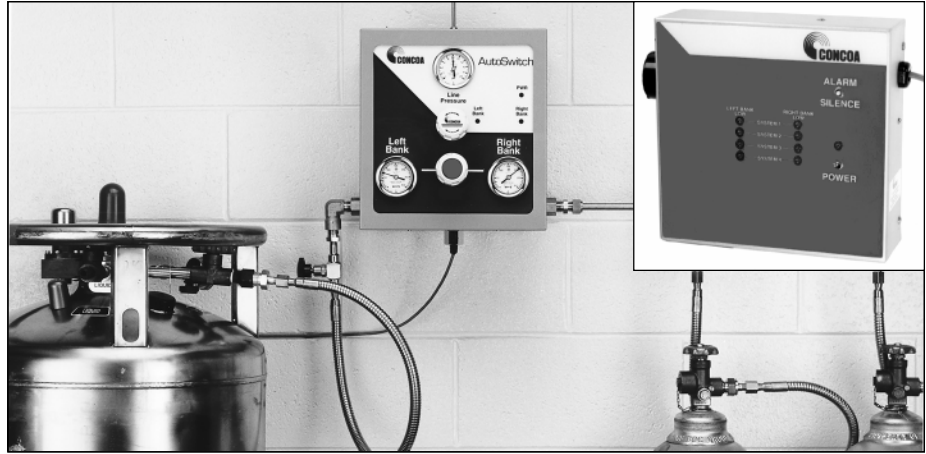

Advanced Features

- *400 Series 316L Stainless Components Capsule® seat*
- *Metal to metal seals*
No possibility of gas contamination
- *Integral Line Regulator*
Stable line pressure during change over
- *Variable Line Pressure*
Line pressure changeable on site
- *Preset Switching Pressure*
Prevents tampering or adjustment
- *Integral Manifold System*
Easy installation

The 537 AutoSwitch GL is a continuous gas delivery system for high purity gas service that automatically changes cylinder or bank priority from a cryogenic source to a reserve bank of high pressure cylinders without transmitting pressure fluctuations to the use line.

Remote Alarm

Providing audible and visible notification of cylinder depletion, a single remote alarm can monitor and power up to four GL models.

Intrinsic Safety Barriers

Safe use with flammable gases or in hazardous areas (class 1, division 1, group A, B, C or D)

Slave Alarms

Three additional alarms provide audible and visible alerts

Telephone Dialer

Notify multiple off-site locations of the need to change depleted cylinders

Computer Interface

Up to 12 channels of information available through analog and digital (RS-232) interfaces

Materials

Priority Valve

316L stainless steel barstock

Line Regulator

316L stainless steel barstock

Diaphragms

316L stainless steel

Enclosure

Acrylic powder-coated steel

Tubing and Fittings

316 stainless steel

Internal Seats and Seals

PTFE Teflon®

Pressure Gauges and Switches

316 stainless steel

Check Valves

316 stainless steel with Viton® seal

Specifications

Maximum Inlet Pressure

3000 PSIG (210 BAR)

3300 PSIG (230 BAR)

available Summer 1999

Temperature Range

-40°F to 140°F (-40°C to 60°C)

Maximum Flow (100 PSIG)

400 scfh (190 lpm)

Inlet Connection (Enclosure)

½" FPT

Outlet Connection

¼" stainless steel compression tube

Helium Leak Integrity

1 x 10⁻⁸ scc/sec

Weight

40 lbs. (18 kg)

See page 26 for manifold specifications

Flow Performance Curves

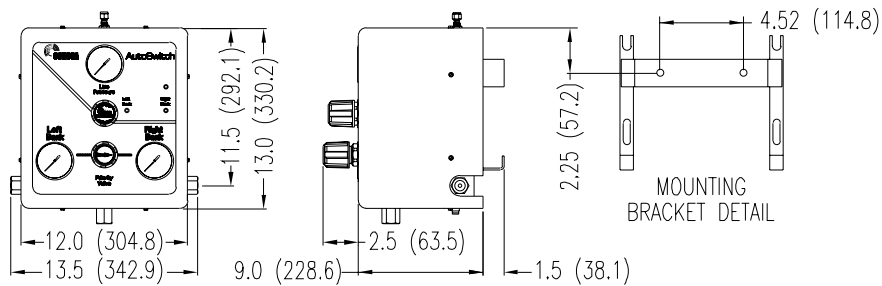
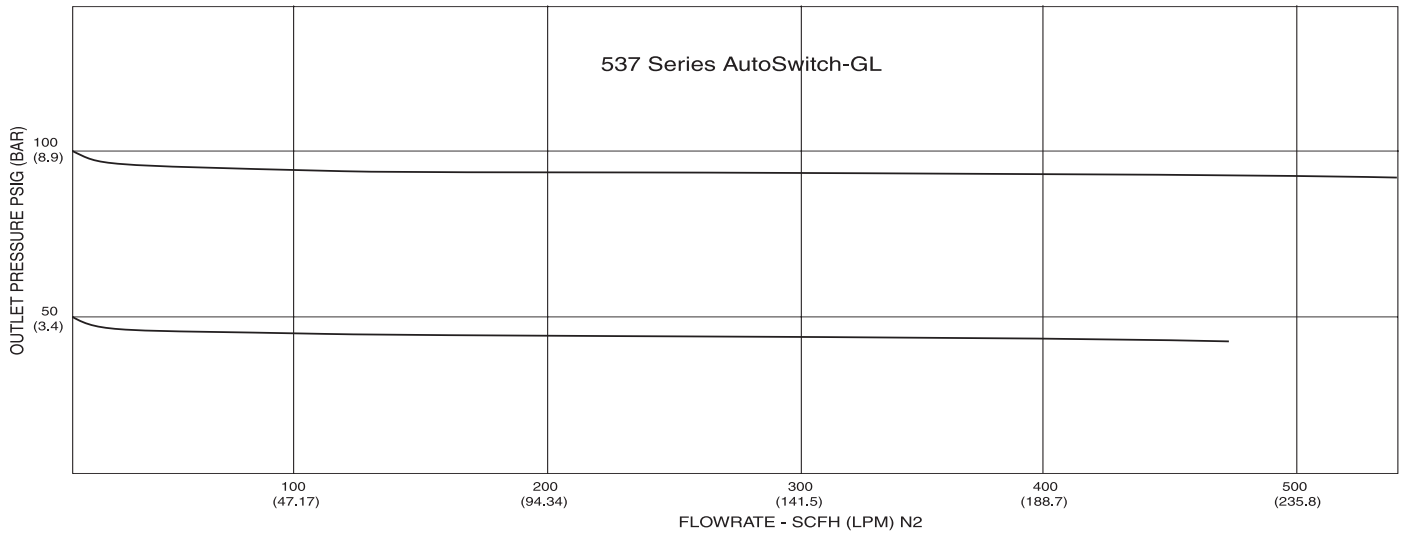

Ordering Information

| 537- | A | B | C | D | -CON |
|-------------------|---|---|---|---|---|
| Series 537 | Outlet Pressure 2: 0-50 PSIG 3: 0-100 PSIG | Liquid Cylinders (Primary) 0: No Inlet Connection 1: One Cylinder* 2: Two Cylinders† 3: Three Cylinders† 4: Four Cylinders† <i>*Includes 36" flexible pigtail and diaphragm valve</i> <i>†Each manifold header includes 36" flexible pigtail, manifold extensions and mounting hardware</i> | High Pressure (Reserve) 0: No Inlet Connection 1: One Cylinder* 2: Two Cylinders† 3: Three Cylinders† 4: Four Cylinders† 5: Five Cylinders† 6: Six Cylinders† <i>*Includes 36" flexible pigtail and diaphragm valve</i> <i>†Each manifold header includes 24" flexible pigtail, manifold extensions and mounting hardware</i> | Assembly 1: Without Pressure Switches* 2: With Remote Alarm (110 VAC) 3: With Remote Alarm (220 VAC) 4: Without Remote Alarm† 5: With Remote Alarm (110 VAC) With Intrinsic Safety Barriers 6: With Remote Alarm (220 VAC) and Intrinsic Safety Barriers 7: Without Remote Alarm With Intrinsic Safety Barriers† <i>*Other assemblies include pressure switches</i> <i>†Requires system with remote alarm</i> | Pigtail Please specify inlet connection (if applicable) CGA DIN 477 BS 341 and others available |

Related Options

| Option | Order No. | Description |
|--------------------------|----------------|---|
| Slave Alarms | 529-5305 | Up to three additional alarms may be connected may be connected to a remote alarm |
| Telephone Dialer | 529-5306 | Alerts remote location of the need to change cylinders via telephone |
| Data Acquisition Package | Contact CONCOA | Hardware and software available |